



System monitoring | Vacuum / Pressure switches

Vacuum / Pressure switches – electronic with digital output

Vacuum / Pressure switches – electronic with digital output

Compact design



Product notes

- > Digital monitoring of vacuum and pressure in handling and automation systems
- > Small, lightweight and compact
- > Transistor output
- > Simple programming of the switching point, hysteresis and switching logic NC/NO
- > Monitoring of a pressure window is possible
- > Locking feature
- > LED operation and status indication
- > Item 20.027: With fitting pipe \varnothing 6 mm to be inserted into tubing or ejectors (e.g. inline or base ejectors)

Technical data

Item no.	20.026	20.027
Adjustable range [mbar (psi)]	-999 - 999 (-14.5 - 14.5)	-999 - 999 (-14.5 - 14.5)
Hysteresis	0 - 100 %	0 - 100 %
Digital switching outputs	PNP Transistor	PNP Transistor
Switching logic	NO/NC	NO/NC
Repeat accuracy [%]	± 0.2 % from measuring range	± 0.2 % from measuring range
Supply voltage [VDC]	9 - 30 (reverse polarity, short circuit protected)	9 - 30 (reverse polarity, short circuit protected)
Current consumption [mA]	< 20	< 20
Maximum switching current [mA]	250	250
Electric connection	Plug M8x1, 4-pin	Plug M8x1, 4-pin
Voltage at the output	ca. Ub -1,5 V	ca. Ub -1,5 V
EMI / EMC	According to EU-directive 2004 / 108 / EG	According to EU-directive 2004 / 108 / EG
Protection class	IP65	IP65
Suitable media	Dry, unooled air and non-abrasive gases	Dry, unooled air and non-abrasive gases
Operating temperature [$^{\circ}$ C ($^{\circ}$ F)]	-10 - 80 (14 - 176)	-10 - 80 (14 - 176)
Suitable accessories	Connector cable: 20.501 Connector cable: 20.502 Adapter: 20.511 Adapter: 20.522 Adapter: 20.523	Connector cable: 20.501 Connector cable: 20.502 Adapter: 20.511 Adapter: 20.522 Adapter: 20.523

Dimensions

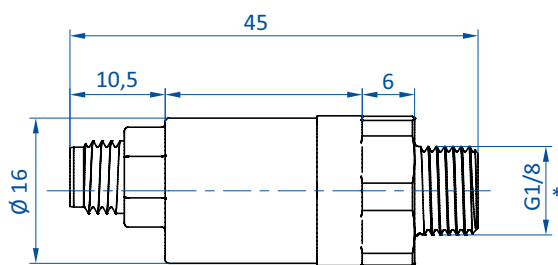

20.026

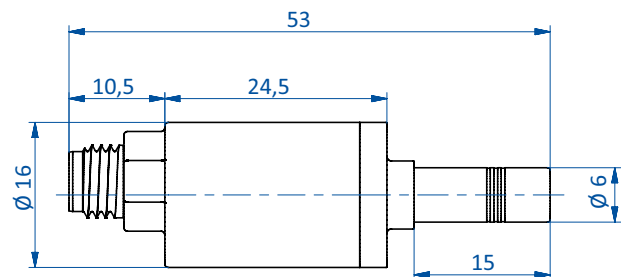

20.027

* = M5-female